

plant design engineers

c o m p a n y p r o f i l e



project management

Complete Services to recognised Quality Systems

pdms modeling

Catalogues, Specifications, Intelligent P&IDs and Pipe Spooling

offshore living quarters

Specialising in Architectural & Interior Design Works



plant design engineers sdn bhd

specialist services to the Oil & Gas and Petrochemical industries

selected projects

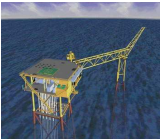

2002 Indonesia

PDMS 3D Model design of Water Treatment platform.

for **Wirazee Engineering & Maxus Southeast Sumatra**

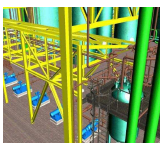

2001 Vietnam/Malaysia

Architectural, structural & services design of Living Quarters & non- accommodation areas - CCR, offices, workshops for Bunga Raya CPP - BRA.

for **Kvaerner Petrominco Engineering, PTSC/Hyundai HI & Lundin Malaysia Ltd**



2002 Myanmar

3D computer animation of construction operations for platform upgrade.

for **Ranhill Worley Sdn Bhd Premier Petroleum Myanmar Ltd**

engineering services

Structural, Piping, Mechanical and E&I Services Design

as-built surveying

On- & off-shore Installations using Laser & Photogrammetry Technology

database management

Development & Long-term EDMS Maintenance

2002 China

Conceptual architectural design & specification for Living Quarters and Technical Rooms for Chunxiao CEP & WHPA platforms; Comprising of 90 man LQ & 3x 8 man LQs + 72 man Removable LQ Module plus CCR, Switchrooms, Workshops etc.
for Technip Malaysia & CNOOC (China) Limited



2002 Brunei

Architectural Design of Fairley-4 Replacement Living Quarters including conceptual & detailed design and specifications.
for Technip Malaysia, Adinin Works & Engineering & Brunei Shell Petroleum



1999 Iran

Architectural detailed design, specification & ID for South Pars Phase 1 comprising Living Quarters (SPQ1), Production (SPP1) & Wellhead (SPD1 & SPD2) Platforms. Comprised of 94 man LQ, CCR, Equipment & Facilities Rooms.
for Technip Malaysia, SADRA-Samsung & Petropars/NIOC



1999 Malaysia

Structural analysis of equipment and piping skids for installation and in-place conditions.
for Salishah & Sons Shipyard & Brunei Shell Petroleum



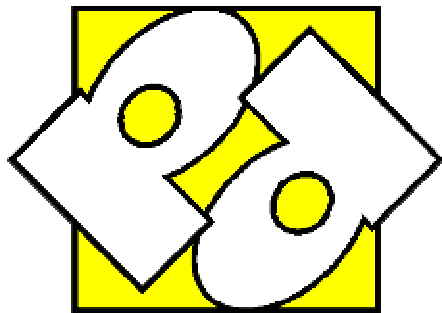

plant design engineers sdn bhd

is a privately held limited liability company operating in **Malaysia** as Valley Pacific Sdn Bhd **since 1999**. Established by industry professionals with extensive experience to provide specialist services to the **Oil & Gas and Petrochemicals industries** in the **Asia Pacific region**.

company details

company type:

Private Limited Liability

certificate of incorporation:

5 8 6 5 7 9 - D

paid-up capital:

R M 1 0 0 , 0 0 0

registered address:

Jalan 2/1A Pandan 2/2
55100 Kuala Lumpur
M a l a y s i a

office address:

8 8 2 B l o c k A 1
Pusat Dagang Setia Jaya
9 J a l a n P J S 8 / 9
46150 Petaling Jaya Selangor
M a l a y s i a

phone

+ 6 0 3 7 8 7 7 8 0 0 1

fax

+ 6 0 3 7 7 2 5 6 9 6 3

email

pdengineers@pdengineers.biz

web

www.pdengineers.biz

www.pdengineers.biz